

SECTION A-A

| ITEM | QTY. | DWG. NO. | DESCRIPTION | APPROX. GALV. WEIGHT | WEIGHT |
|------|------|-----------|-------------------------------------|----------------------|--------|
| 6. | 16 | C40034028 | U-BOLT ASSEMBLY, 5/8"φ X 4 3/16 C/C | | 30.7# |
| 5. | 4 | C40026025 | BOLT ASSEMBLY, 5/8"φ X 2 1/2 A325 | | 1.9# |
| 4. | 4 | CS00071 | PIPE CROSSOVER PLATE | | 32.0# |
| 3. | 1 | CS00038 | T-ARM CROSSOVER PLATE | | 22.0# |
| 2. | 1 | CW00015 | SUPPORT PIPE | | 93.3# |
| 1. | 1 | CW00144 | T-ARM WELDMENT | | 64.9# |

LIST OF MATERIAL

NOTES:

1. TRI-COLLAR MOUNTS MUST BE PURCHASED SEPARATELY.
2. 2 3/8" O.D. MOUNTING PIPE & U-BOLTS MUST BE PURCHASED SEPARATELY.
3. FOUR (4) PIPE CROSSOVER PLATES ARE SUPPLIED WITH EACH T-ARM ASSEMBLY, REGARDLESS OF QUANTITY OF PIPES PURCHASED.
4. QUANTITIES SHOWN IN LIST OF MATERIAL ARE FOR ONE (1) T-ARM ASSEMBLY ONLY.

| | | | |
|--|------|---|-------------|
| UNLESS OTHERWISE SPECIFIED ALL DIMENSIONS INCLUDE FINISHES AND ARE IN INCHES | | MATERIAL: | |
| TOLERANCES: FRACTIONS ± 1/16" ANGLES ± 1/2 DEG. DECIMALS ± .010" | | TOLERANCES DO NOT APPLY TO RAW MATERIAL | |
| REV | DATE | DRW/CHK | DESCRIPTION |
| | | | |
| | | | |
| | | | |
| | | | |
| | | | |

Sabre Industries™
Towers and Poles

CONFIDENTIAL

This document and the information contained herein is the confidential trade secret property of Sabre Communications Corporation ("Sabre") and must not be reproduced, copied or used, in whole or in part, for any purpose without the prior written consent of Sabre.
© 2014 Sabre Communications Corporation. All rights reserved.

| | | | | | |
|--|---------|-----------------|-----------|--------------------------|----------------|
| T-ARM ASSEMBLY 3'-0" ARM WITH 10'-0" FACE | | REF. 9028721 | SIZE B | DRAWING NO. C10113181 | REV 0 |
| DATE | 3/29/04 | DRAWN BY MLC | | SCALE None | PAGE 1 OF 1 |
| CHECKED BY MC | | | | | |



C10112300 TRI-COLLAR ASSEMBLY (10"-40" MONOPOLE)

| ITEM | QTY. | PART. NO. | DESCRIPTION | WEIGHT |
|--------------|------|-----------|---|--------|
| 1. | 3 | CW00835 | WELDMENT, TRI-COLLAR (10"-40" MONOPOLE) | 151 |
| 2. | 6 | C40094012 | THREADED ROD ASSEMBLY 5/8 X 2'-9" | 25 |
| 3. | 6 | C40094002 | THREADED ROD ASSEMBLY 5/8 X 1'-6" | 17 |
| TOTAL WEIGHT | | | | 193 |

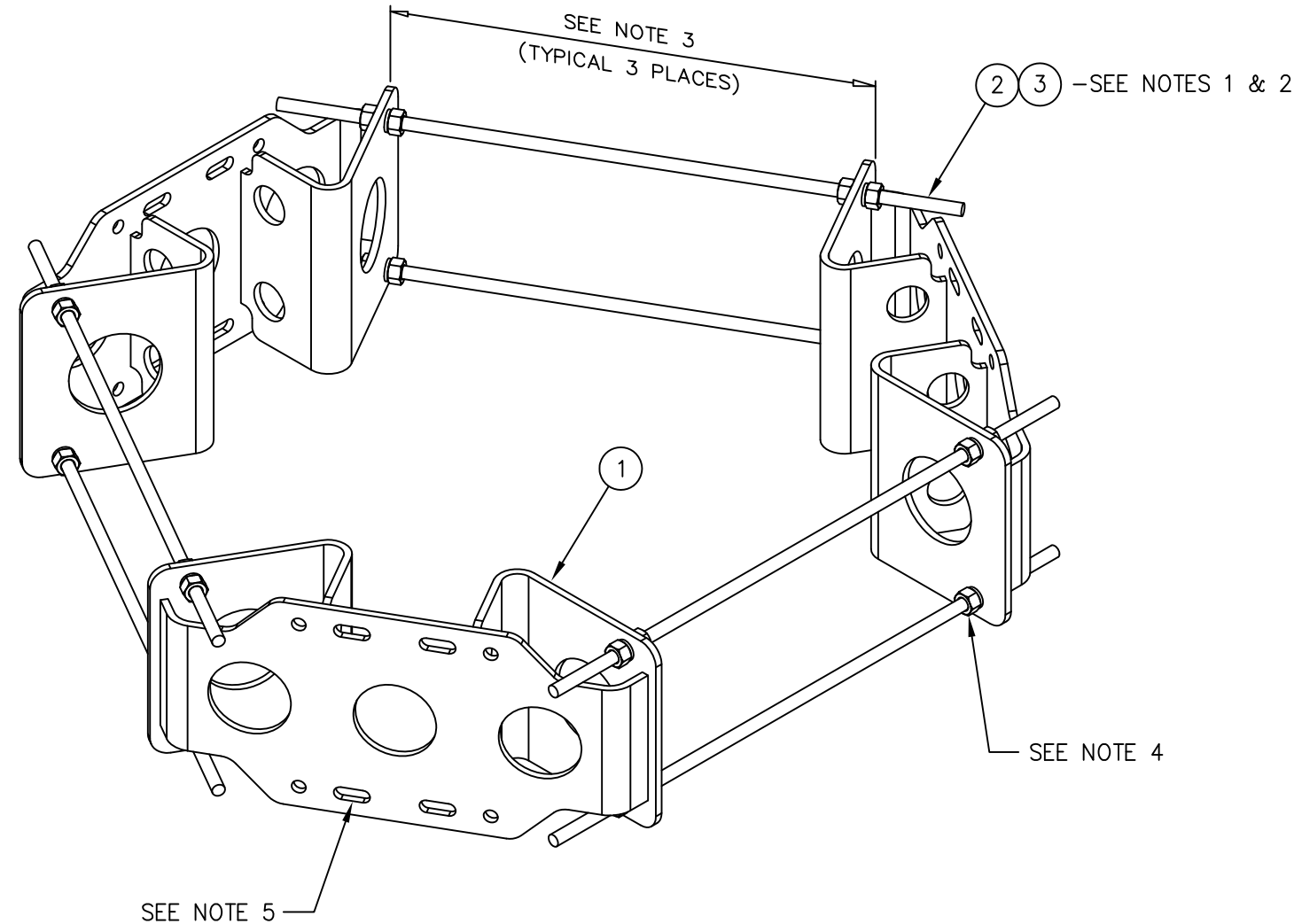

ISOMETRIC VIEW

NOTES:

1. THERE ARE (2) LENGTHS OF THREADED ROD SUPPLIED TO ACCOMMODATE DIAMETERS LISTED BELOW
 USE 5/8 X 1'-6" THREADED ROD ASSEMBLY FOR 10"-24" MONOPOLE DIAMETERS
 USE 5/8 X 2'-9" THREADED ROD ASSEMBLY FOR 24"-40" MONOPOLE DIAMETERS (SEE NOTE 2)
2. THREADED ROD MAY BE SHORTENED IF REQUIRED, FIELD CUT AND COLD GALV SPRAY TO SUIT.
3. THIS DISTANCE MUST BE EQUAL IN ALL (3) THREE LOCATIONS TO ENSURE THE STRUCTURAL INTEGRITY OF THE THREADED RODS AS WELL AS 120° SEPARATION.
4. FOR MONOPOLES 13" DIA. OR SMALLER, ONLY (1) ONE NUT AND (1) ONE LOCKWASHER ARE REQUIRED BETWEEN THE TRI-COLLAR BRACKETS.
 FOR MONOPOLES LARGER THAN 13" DIA., (2) TWO NUTS AND (2) TWO LOCKWASHERS ARE REQUIRED BETWEEN THE TRI-COLLAR BRACKETS.
5. THE MOUNTING SLOTS NOTED WILL ACCOMMODATE 2 3/8"-4 1/2" O.D. MOUNTING PIPES.

UNLESS OTHERWISE SPECIFIED
 ALL DIMENSIONS INCLUDE
 FINISHES AND ARE IN INCHES
 TOLERANCES: FRACTIONS ± 1/16"
 ANGLES ± 1/2 DEG.
 DECIMALS ± .010"

MATERIAL:
 TOLERANCES DO NOT APPLY
 TO RAW MATERIAL



TRI-COLLAR BRACKET ASSEMBLY
 FOR MONOPOLES (10"-40" DIA.)
 (CIRCUMFERENCE 31.4" TO 125.7")

| REV | DATE | DRW | CHK | DESCRIPTION |
|-----|---------|-----|-----|--------------------------------|
| 2 | 8/11/10 | DLW | DEL | ADDED 5/8 X 1'-6" THREADED ROD |
| 1 | 1/6/10 | MLC | MC | REDRAWN IN AUTOCAD |

CONFIDENTIAL
 This document and the information contained herein is the confidential trade secret property of Sabre Communications Corporation ("Sabre") and must not be reproduced, copied or used, in whole or in part, for any purpose without the prior written consent of Sabre.
 © 2014 Sabre Communications Corporation. All rights reserved.

| DATE | 8/21/09 | SIZE | B | DRAWING NO. | C10112300 | REV | 2 |
|----------|---------|------------|-----|-------------|-----------|------|--------|
| DRAWN BY | JV | CHECKED BY | MLC | SCALE | None | PAGE | 1 OF 1 |